

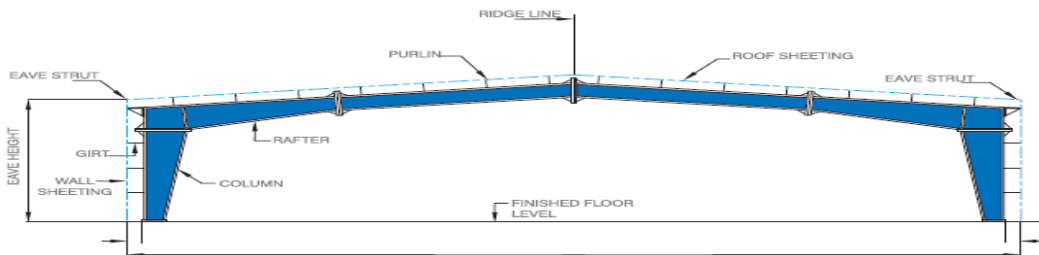

SEMCO INFRACON



Pre-Engineered Building & Construction

SEMCO INFRACON

Capital City Mahindra Gate No -1 / Bldg 'A' Floor No -4 / Off No -11 / 12 Nighoje Chakan Pune - 410 501

Ref No: - SGPEB/Q-18/21 - 22

DATE : - 12.12.2021

PROPOSAL

**Bhuseva Farmers Producer
Co.Ltd**

PEB SHED AT MOHOL

CONTACT PERSONS

Mr - V.R. SAKHARE - 88 55 99 08 77 & Mr - R.S. DESHINGE - 95 52 56 30 05

semcoinfracon@gmail.com

www.semcopune.com / www.semkogroup.in

PEB SHED BUILDING DETAILS

1	Type Of Building	P.E.B. SHED BUILDING CLEAR SPAN
2	Building Width (Mtr)	18.28 MTR of Column Base. (Approx)
3	Building Length (Mtr)	30.487 MTR of Column Base. (Approx)
4	Building Clear Main Eave Height (Mtr)	Shed Center Height –(10.67 Mtr) & Man Colum Height-(9.5Mtr) And Both Side Cladding Sheet Height (8.5 Mtr)
5	Building Roof Slop	1/10
6	Building Bay Spacing	4 @ 7.621 Mtr C/C (Approx) /As Per Building Design
7	Type End Frames Both Side	Rigid frame with gable column
8	Type Of Building In Side Wall	Side Wall (3 mtr)
9	Type Of Eave	EDGED
10	Building Crane	No

PAYMENT TERMS

45% Advance along with / PO
40% against Delivery of Material At Site.
13% Against Start of sheeting work.
2% After Completion Of Work.

PURCHASE ORDER

Release Purchase order within 10 days of Proposal mentioning above payment terms & Proposal Condition Are Accepted.

PEB QUOTATION

Bhuseva Farmers Producer Co.Ltd.

22/1/C, Angar wafle Road, Khandobachiwadi Tal-Mohol, Dist-Solapur-413214

PEB SHED

S.NO	DESCRIPTION	UNIT	QTY	RATE	AMOUNT
A } PRIMARY STEEL					
1	Main Shed Frames & End Wall Column	Kg	13856	104	1441024
2	Canopy - 02 NOS				
B } SECONDARY					
3	Anchor Bolt And Template	Kg	280	94	26320
4	Angle Bracing / Bracings Rods /Sag Rods /Connection Clips	Kg	1750	94	164500
5	Purling & Side Girt - Z / C	Kg	5750	94	540500
6	Hardware - [8.8 Grade]	Kg	290	144	41760
7	Hardware - [4.6 Grade]	Kg	510	94	47940
8	Coated Sheet Roofing & Wall Cladding - 0.5 Thk [PPGI]	Kg	7512	108	811296
9	Poly Carbonate Sheet - 1070 X 3300 X 2 MM - 04 NOS	Sq.m			
10	Turbo Ventilator - 22 "	Nos			
11	Hill Washer	Nos	14.13	1450	20488.5
12	Self Tap Scru - 25 mm & 55 mm	Nos	12	6200	74400
13	Ridge Panel - 1070 X 1000 ----- 31 NOS	Sq . Mtr	64	115	7360
14	Gable Flashing	R . Mtr	11040	2.8	30912
15	Corner Flashing	R . Mtr	40.2	360	14472
16	Canopy Bootm Flashing	R . Mtr	64	360	23040
17	Canopy Corner 1070 X 1000 ----- 14 NOS	Sq . Mtr	56	360	20160
18	Canopy ' L ' Corner	R . Mtr	22	360	7920
19	GI Gable Angle - 100 x 100 x 1.5 mm	Kg	33	360	11994
		A]	Basic Rates Amount		3316714
		B]	Profile	2%	66223
		C]	DWG	1.25	41390
		D]	Transport	1.30	43045
		E]	Total Basic Amount		3467376
		F]	GST	18%	624128
		G]	Total Amount		4091503

1]	Shed Area -W - 15.243 M X L- 30.487 M X H - 6.5 MTR	Sq Feet	6000
2]	All Taxes Applicable As Per Government Rules @ GST - 18 %	Total Weight	19839
3]	All Material Primary Steel & Secondary With Material Basic Rates.		
4]	All Rates are Included with Erection Charges & Sheet Fixing Installation Charges.		
5]	Also Rates Include Accessories Fixing Installation Charges.		
6]	Coated Sheet Roof Sheets & Wall Cladding (90 Gsm, 245 Mpa PPGI) (AM / ESSAR / BHUSHAN)		

NOTE :-

- 1) Above specified rates are today's market based rates and these rates are valid for only **5** days. After **5** days rates will be varies as per Market price after getting Po.
- 2) The completion period is fix as per our commitment but due to present lockdown circumstances The given date may get extend. The said situation is unavoidable, please have a note.



Semco Infracon
PEB BUILDING SHED

MR-SAKHARE - M.NO - 8855990877



**Kind
Attn**

MATERIAL

S.NO	DESCRIPTION	TOTAL WT
A } PRIMARY STEEL		
1	Main Shed Frames & End Wall Column (PLATE YST - 250)	9122
2	Canopy - 02 NOS	
B } SECONDARY		
3	Anchor Bolt And Template	280
4	Angle Bracing / Bracings Rods /Sag Rods /Connection Clips	1235
5	Purling & Side Girt - Z / C	3750
6	Hardware - [8.8 Grade]	290
7	Hardware - [4.6 Grade]	210
8	Coated Sheet Roofing & Wall Cladding - 0.5 Thk { PPGI}	4952
TOTAL APROX WT --		19839

MATERIAL SPECIFICATIONS

S.NO	DESCRIPTION	MATERIL	GRADE	MAKE
PRIMARY STEEL / SECONDARY				
1	ALL Column & Rafter	PLATE	YST - E 250 / BR	JSW / SAIL
2	Crane Girders And Canopy			
3	Anchor Bolt	M.S. BAR	E - 250 / B	PUSHPAK/MAHAVIR STEEL
4	Bracings Rods / Sag Rods			
5	Primer Paint	PRIMARY STEEL	35 / DFT	ASIAN / BURGER
6	Final Finish Paint	PRIMARY STEEL	35 / DFT	ASIAN / BURGER
7	Purling - Z / C (ESSAR)	Purling	80 GSM, 245 MPA, G.I	1.5 MM & 2 MM Thick
8	Hardware	BOLT / NUT	4.6 / 8.8	PLATED
9	Coated Sheet (PPGI)	SHEET	90 Gsm, 245 Mpa	0.5 Thk { PPGI }
10	Hill Washer	M.S		PLATED
11	Self Tap Scru - HP	SCRU	25 MM & 55 MM	(ASTM B117)
12	Ridge Panel	ALL ACCESSORIES AS PER QUOTATION QTY	(PPGI)	Coated 0.5 Thk { PPGI }
13	Gable Trim			
14	Drip Trim			
15	Corner Trim			
16	Wide Eave Gutter			
17	Standard Downspout			
18	Canopy Corner Trim			

NOTE :-

- 1) The completion period is for as per our commitment but due to present Lockdown circumstances the given date may get extend. The said Situation is unavoidable, please have a note.



SEMCO GROUP

PEB BUILDING SHED

MR-SAKHARE - M.NO - 8855990877



Kind Attn